

# Godox®

## REMOTE SPEEDLITE TRIGGER 机顶闪光灯触发器

[www.godox.com](http://www.godox.com)

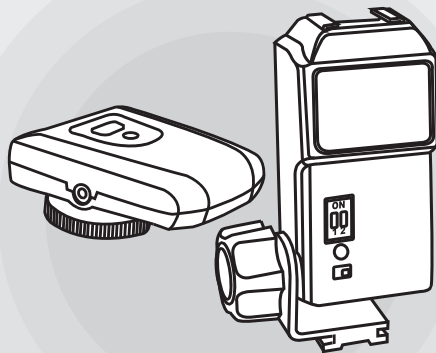

深圳市神牛摄影器材有限公司  
GODOX PHOTO EQUIPMENT CO. LTD  
地址 / Add: 深圳市宝安区福永镇福海大道新和村华发工业区A4栋2楼  
2/F, Building A4, Xinhe Huafa Industrial Zone, Fuhai RD, Fuyong  
Town, Baoan District, Shenzhen 518103, China  
电话 / Tel: 0755-29609320 传真 / Fax: 0755-29596412  
邮箱 / E-mail: [godox@godox.com](mailto:godox@godox.com)

**CT** SERIES

PROFESSIONAL PHOTO ACCESSORIES

Made in china



神牛专业摄影附件

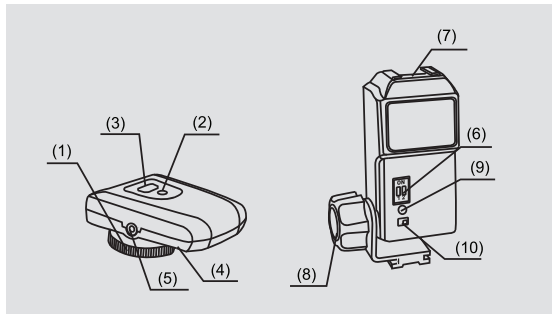

## 【主要部件名称】

- |              |              |
|--------------|--------------|
| (1) 热靴插座     | (6) 频道设定拨码开关 |
| (2) 发射工作指示灯  | (7) 热靴插座     |
| (3) 测试按钮     | (8) 接收器固定旋钮  |
| (4) 频道设定拨码开关 | (9) 触发信号指示灯  |
| (5) X同步线插孔   | (10) 电源开关    |

非常感谢您购买神牛机顶闪光灯触发器。他适用于多种拍摄任务，可同步遥控触发机顶闪光灯。

## 【产品特点】

无线控制	超低电压	低压触发	频道隔离
操作便利	节省电池	无损相机	独立控制

## 【主要参数】

- |                   |                |
|-------------------|----------------|
| 1.电源：2AAA         | 4.室内工作距离：大约20m |
| 2.频道：4            | 5.同步速度：1/250秒  |
| 3.室外工作距离：大约20-30m |                |

## 【使用方法】

1. 将发射头插入相机热靴插座并锁紧，设置同一频道数。

2. 将闪光灯插入接收器热靴插座，设置相机为远距离快门。

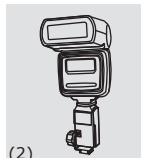

## 【注意事项】

1. 使用电源要与本机相符
2. 电池将要耗尽时，可见发射器的工作指示灯暗淡，此时需要更换新电池。
3. 避免跌摔及与硬物碰撞。
4. 保持干燥，避免电击、淋水或过分潮湿

## 【频道编码配对设定方法】

在本产品触发器发射器的外壳底面与接收器的外壳正面，设有2位拨码开关，只有发射器与接收器的频道拨码开关拨至相同状态，两者才能正常工作，发射机不会触发处于其他编码状态的接收器。

频道号码如下表(说明：拨码开关的白色手柄拨向数字，按照下列表格选编频道表示.)

频道	1	2	3	4
接收器	NO 1 2	NO 1 2	NO 1 2	NO 1 2
发射器	NO 1 2	NO 1 2	NO 1 2	NO 1 2

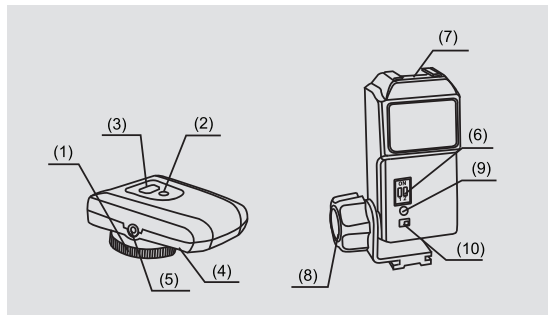

### Part A: Transmitter

- (1) Hot shoe
- (2) Receiving indicator lamp
- (3) Test button
- (4) Channel code switch
- (5) Sync cord jack

### Part B: Receiver

- (6) Channel code switch
- (7) Camera hot shoe
- (8) Fix knob
- (9) Transmitter indicator lamp
- (10) Power switch

### Introduction:

Thank you for your purchase of our speedlite remote trigger. The product is suited to a wide variety of tasks. It is control discreteness for camera to trigger hot shoe flashgun synchronously.

## Please refer to the main features as follows:

- Remote wireless control, effective remote distance(open space):30m.
- 4-unique-channel supports multiple users' environment.
- Strong interference-resistance capacity.
- Exhausted power consumption design benefits a longer period of use.
- Convenient operation
- Low voltage trigger
- No harmful to camera

## 【 Main parameters 】

- |  |  |
|--|--|
| 1. Power: 2AAA                                 | 4. Indoor operation distance:<br>about 20m |
| 2. Channel: 4                                  | 5. Sync speed: 1/200sec.                   |
| 3. Outdoor operation distance:<br>about 20-30m |  |

## 【 Using method 】

(1). Insert the transmitter to camera hot mount directly w/screw lock system .Turn on the camera and transmitter and set in same channel.



(2). Attach camera flash to receiver hot mount. Press camera shutter ready for instant using.



## Precautions for Use

- Use only the prescribed battery.
- Please change batteries before they run down in case of shot omission.
- Please do not connect or disassemble the receiver under the state of camera power-on.
- Please do make the connector connected firmly to avoid problems in operation.
- Avoid water and hot environment conditions

## Channel Selecting

Please switch off the power of the receiver, then keep both the transmitter and receiver in the same channel codes,and switch the power on to work again.

## Description:

Channel NO.	1	2	3	4
Receiver	NO 1 2	NO 1 2	NO 1 2	NO 1 2
Emitter	NO 1 2	NO 1 2	NO 1 2	NO 1 2