

深圳市神牛摄影器材有限公司

GODOX Photo Equipment Co., Ltd.

地址/Add: 深圳市宝安区福永镇福海大道西新和村华发工业园A4栋
Building A4, Xinhe Huafa Industrial Zone, Fuhai RD West, Fuyong
Town, Baoan District, Shenzhen 518103, China

电话/Tel: +86-755-25701197 / +86-755-25726373

传真/Fax: +86-755-25723423

邮箱/E-mail: godox@godox.com

82.A000EZA0-00

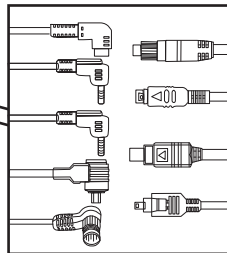

Godox 神牛

EZa

说明手册
Instruction Manual

Digital Timer Remote

定时快门遥控器

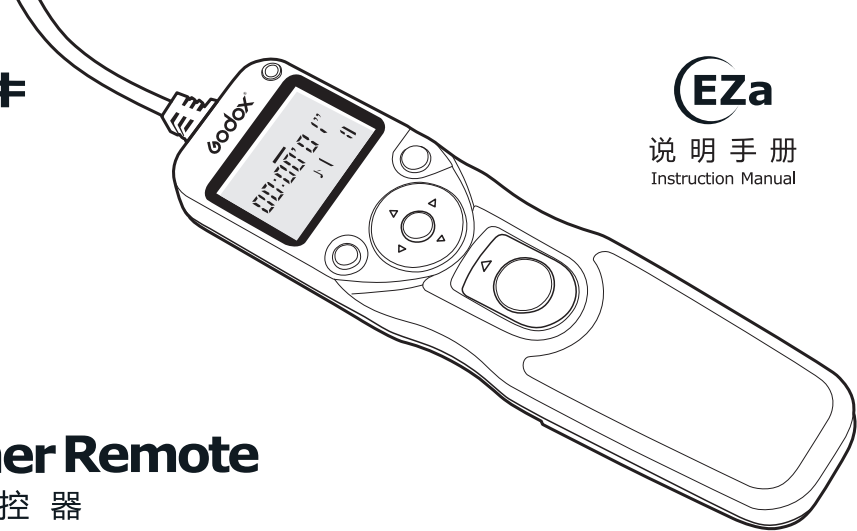

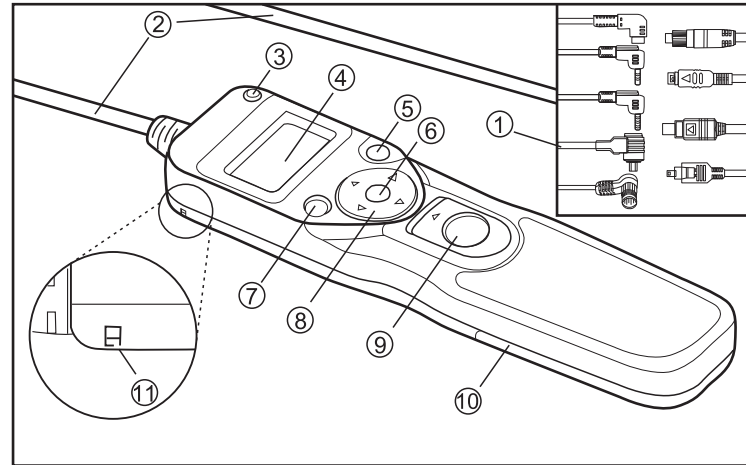

机身

1. 插头 (多种型号可选择)
2. 连接线
3. 对焦及释放双色指示灯
4. 显示面板
5. 定时器启动 / 停止按钮
6. 设定按钮
7. (照明 / 锁定) 按钮
8. 箭头按钮
9. 快门释放按钮
10. 电池盒盖
11. 定时器背带的固定扣

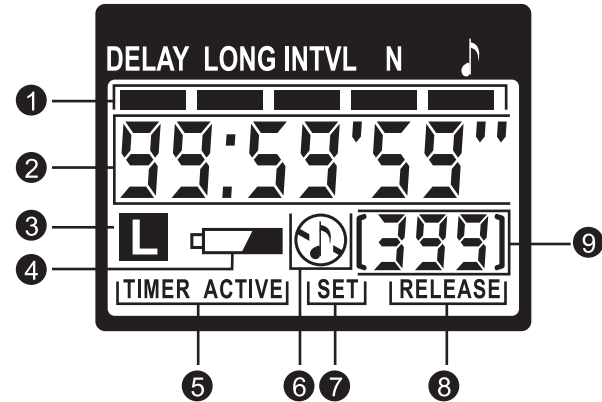

显示面板

1. 功能光标
2. 时间显示
3. 锁定指示
4. 低电池电量指示
5. 定时器启动指示
6. 扬声器开启、关闭指示
7. 设定指示
8. 释放指示
9. 拍摄张数

前言

感谢您购买快门遥控线。该快门遥控线配备的间隔定时器适合多种拍摄任务，其中包括天文摄影。

目录

安全须知	04
EZa部件	01
机身	01
显示面板	02
安装电池	06
更换电池	06
不使用快门遥控器时	06
照明 / 锁定按钮	07
连接	08
使用	08
定时摄影	09
手动释放	14
使用上的注意事项	16
EZa的保养	16
端子型号&对应相机型号.....	17
技术规格	18

! 安全须知

- 为防止损坏您的相机，或避免您或他人受伤，在使用本设备前请仔细阅读下面的安全须知，并妥善保管以便所有本产品使用者可随时参阅。
- 请遵守本节中所列举的用以下符号所标注的各项预防措施，否则可能对产品造成损害。

! 该标记表示警告，提请您应该在使用本产品前阅读这些信息，以防止可能发生的损害。

! 请勿拆卸或改造

违反此警告可能会触电或导致产品故障。若本产品因为摔落或其他意外事故造成破损，请取出电池并将产品送至厂家授权的维修中心进行检查维修。

! 保持干燥

请勿用湿手接触产品，亦不可将产品浸入水中或暴露于雨中，否则可能引起火灾或触电。

! 请勿在易燃气体环境中使用

违反此警告可能引起爆炸或火灾。

！ 请勿在儿童伸手可及之处保管本产品
 本产品包含可能引起窒息的零件。如果儿童不小心吞食了零件，请立即送往医院救治。

！ 若发生任何故障，请立即关闭相机电源
 若发现本产品冒烟或发出异味，请立即取出电池并将本产品送至授权的维修中心进行检查维修，以避免燃烧。若在此情景下继续使用，可导致受伤。

！ 请勿置于高温中
 请勿将本产品放置于阳光直射下的封闭车辆内或其他极高温的地方，否则可能导致火灾或损坏本产品的外壳或内部部件。

！ 使用电池的注意事项
 操作不当可能导致电池漏液或爆裂，因此在本产品中使用电池时请注意以下事项：

- * 只能使用本手册中列出的电池。请勿混用新旧电池或不同类型的电池。
- * 请仔细阅读并遵守由厂商提供的警告或指示。
- * 切勿使电池短路或拆卸电池。
- * 切勿将电池投入火中或加热升温。
- * 切勿试图以反方向安装电池。
- * 当电量用尽时，电池容易漏液。所以为了避免产品受损，请在长期不使用本产品或电量用尽时取出电池。
- * 如受损电池中的液体接触到皮肤或衣服，请立即用大量清水冲洗。

安装电池

请按图中所示，滑开背面的电池盒(⑩)盖并装入两节AAA 1.5V碱性电池(另行选购)。

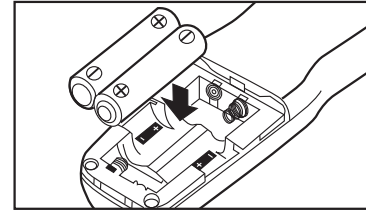

低电池电量指示 ()

电池电量较低时，低电池电量指示(④)将闪烁。请更换电池。

更换电池

- 更换电池时，请执行以下步骤：
1. 请确认控制面板中未显示“**TIMER ACTIVE**(定时器启动)”(⑤)和“**RELEASE**(释放)”(⑧)指示。
 2. 关闭相机电源并断开与快门遥控线的连接。
 3. 取出电池
 4. 请稍候，待控制面板背光熄灭后再接入新的电池。

不使用快门遥控线时

快门遥控线没有设定电源关闭开关。不使用时，为了减少电池电量消耗，请结束拍摄并确保控制面板中未显示“**TIMER ACTIVE**(定时器启动)”(⑤)、“**set**(设定)”(⑦)和“**RELEASE**(释放)”(⑧)指示。当这些指示闪烁时，电池电量的消耗将会增加。

“TIMER ACTIVE”、“SET”和“RELEASE”指示

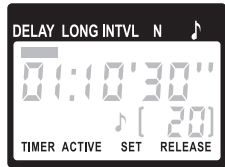

以下指示闪烁	表达意思：关闭方法
TIMER ACTIVE (定时器启动)	定时器已启动；按下 TIMER ACTIVE/SHOP (定时器启动/停止)按钮(⑤)。
SET (设定)	可修改设定； 按下 SET (设定)按钮(⑥)。
RELEASE (释放) (TIMER ACTIVE 未闪烁)	手动释放已开启；松开快门释放按钮(⑨)； 若按钮在 HOLD (保持)状态，请解除快门释放锁定。

照明/锁定按钮

按下照明/锁定按钮(⑦)将暂时激活控制面板的背光。背光将持续点亮6秒钟；在背光亮着时按下箭头按钮(⑧)可使定时器背光再延长6秒钟。
若要锁定除快门释放(⑨)和照明/锁定按钮以外的控制器，请按下照明/锁定按钮，直至控制面板中出现锁定图标。若要解除锁定，请按下照明/锁定按钮，直至锁定图标消失。

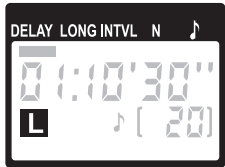

连接

1. 关闭相机电源
2. 请确认控制面板中未显示“**TIMER ACTIVE**(定时器启动)”(⑤)和“**RELEASE**(释放指示)”(⑧)。
3. 取下相机上的快门插座终端盖。按相机的快门连接方式，将快门插头(①)与相机牢固连接。

断开与快门遥控线的连接

在确认没有显示“**TIMER ACTIVE**(定时器启动)”(⑤)和“**RELEASE**(释放)”(⑧)指示之后，请关闭相机并断开快门遥控线的连接，然后盖上快门插座终端盖。

使用

快门遥控线具有以下功能：

自动定时器——请选择定时间隔拍摄的延迟时间（拍摄开始前的时间长度）、曝光时间、间隔时间和拍摄数量。您也可以根据需要使用相机来选择快门速度。

手动释放——使用快门遥控线上的快门释放按钮来手动拍摄照片。即使启动了定时器，您也可以进行手动拍摄。

定时摄影

1、调整相机设置

1.1 连接快门遥控线并开启相机。

1.2 按照以下设置来调整相机：

曝光模式	M (手动)
快门速度	长时间曝光
间隔定时器	关闭
对焦模式	AF-C (连续伺服自动对焦) 或 M (手动)
连拍	S (单张)

2、设定定时器

2.1 按下SET(设定)按钮。显示面板中将闪烁“SET(设定)”指示。

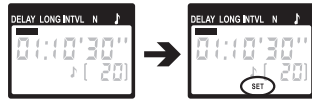

2.2 调整以下设置：

选项	说明	支持的设置
延迟	快门释放前延迟的时间	0秒至99小时59分59秒 (以1秒为增量)
长度	曝光时间	
间隔	间隔时间	1秒至99小时59分59秒 (以1秒为增量)
数量	拍摄张数	1至399, -- (不限定)
🎵	扬声器开启/关闭	🎵 开启, 🎵 关闭

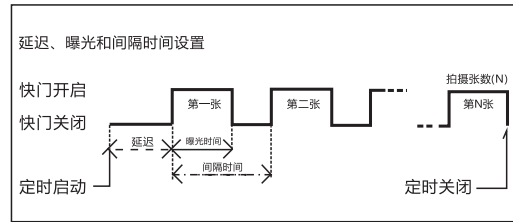

设定定时器

请使用箭头按钮来设定定时器。向右或向左按下按钮进行选择，向上或向下按下按钮进行更改设置。当前选项将用选定光标(1)标识。



调整
设置

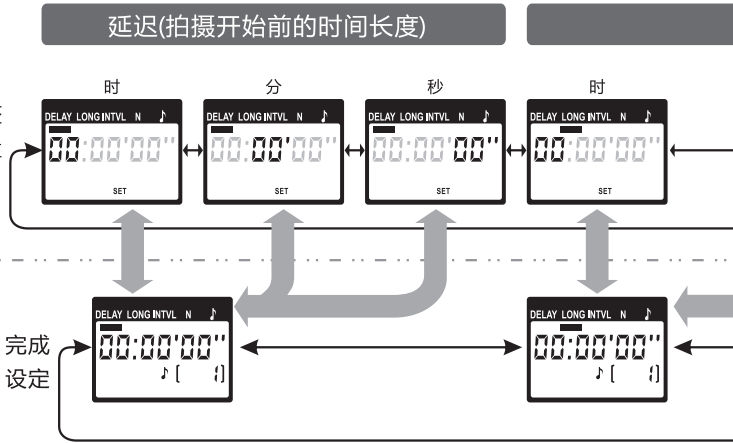

随时按下SET(设定)按钮(6)均可完成操作并显示所选项目的新设置。若要查看其他设定，请向左或向右按下箭头按钮。当前选项将用选定光标(1)标识。请按照上述说明按下SET(设定)按钮以编辑当前设置。

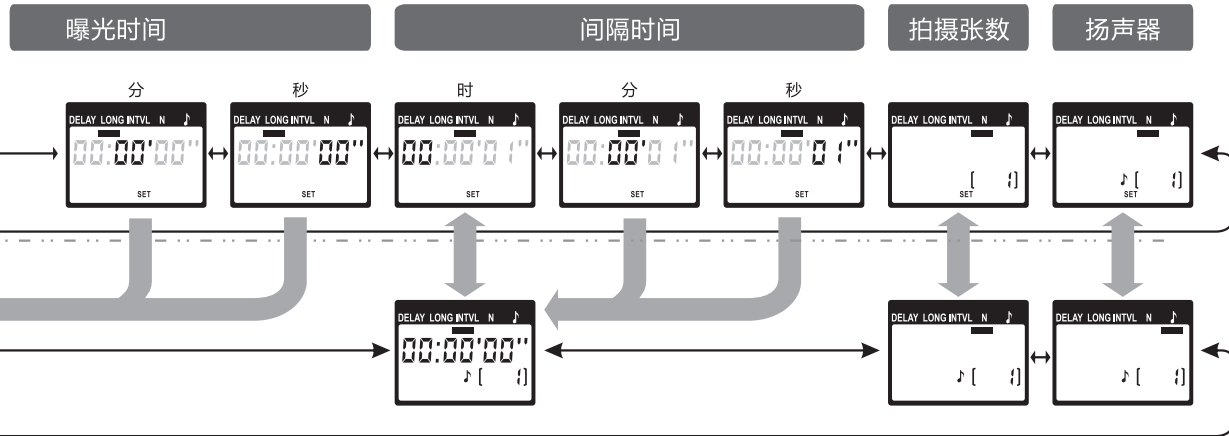

设定定时器

为确保正确操作，请选择比曝光时间至少长1秒的间隔时间。为确保相机有充足的时间对焦，使用自动对焦时，请将延迟时间至少长3秒或更长，并选择比曝光时间至少长3秒的间隔时间。当使用长时间曝光NR功能时（仅适用于某些数码相机），间隔时间至少应该是曝光时间的两倍。

按下**SET**(设定)按钮(⑥)使设置立即生效后，间隔时间00:00:00将自动被设定为00:00:01。

若要将拍摄张数设定为--（不限定），请选择1并向下按下箭头按钮(⑧)，或是选择**399**并向上按下箭头按钮。

2.3 根据需要调整设置之后，按下**SET**(设定)按钮(⑥)即可使新设置生效。此时，定时器将发出一次哔声（在扬声器开启的情况下），“**SET**(设定)”指示亦将消失。

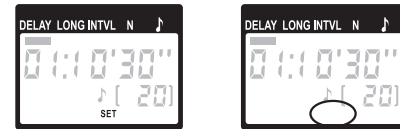

新设置会持续生效，除非被更改，或是电池被取出或电量耗尽时。

3. 启动定时器

按下**TIMER STSRT/SHOP**(定时器启动/停止按钮) (⑤)后，定时器将会启动，并且显示面板中将闪烁“**TIMER ACTIVE**(定时器启动)” (⑤)指示。在间隔拍摄之间，显示面板中将会持续显示拍摄下一张照片之前的剩余时间。在快门打开之前3秒对焦输出，对焦及释放指示灯亮绿灯。

快门开启时，显示面板中将显示快门关闭前的剩余时间，同时“**RELEASE**(释放)”指示(⑧)每秒闪烁一次。对焦及释放指示灯亮红灯。若扬声器已开启，定时器将以1秒为间隔发出哔声，每拍摄一张照片之后，剩余可拍摄张数将更新。

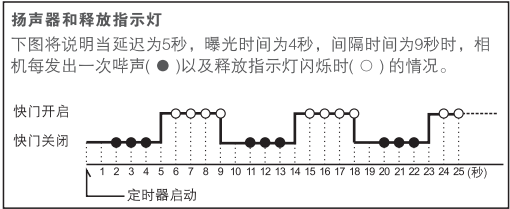
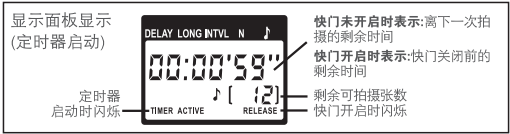

4. 结束拍摄

当定时数完成所选数量的拍摄之后，拍摄将会自动结束。若要在所有照片被拍摄完之前结束拍摄任务，请按下**TIMER START/SHOP**(定时器启动/停止)按钮(⑤)。

使用相机选择快门速度

若要使用由相机设定的快门速度来拍摄照片，请按下表所示调整设置。

相机	曝光时间	手动或快门优先自动
	快门速度	任意速度
	间隔定时器	关闭
	对焦模式	连续伺服自动对焦或手动
	拍摄模式	单张
Eza	曝光时间	0秒
	间隔时间	大于相机快门速度

使用定时器

在长时间使用定时器之前，请确保电池电量充足。当显示面板(④)中闪烁低电池电量指示()时，请更换电池。

手动释放

EZa快门释放按钮(⑨)和快门释放按钮具有大致相同的功能。

1. 调整相机设置

请连接EZa并打开相机，然后根据需要选择曝光模式、快门速度、对焦模式和拍摄模式。

2. 拍摄照片

2.1 半按下EZa快门释放按钮(⑨)对焦输出，对焦及释放指示灯亮绿色。然后将其完全按下以拍摄照片。快门开启时，对焦及释放指示灯亮红灯相机每隔1秒发出一次哔声，“**RELEASE**(释放)”指示(⑧)将闪烁，并且显示面板中将显示快门已开启时间。

在进行长时间曝光摄影时，若需持续按住快门释放按钮，请将该按钮滑至**HOLD**保持位置。朝相反方向滑动该按钮即可解除锁定。



2.2 释放快门按钮以结束拍摄。

EZa的快门释放按钮可以在未安装电池时使用。这种情况下，显示面板将保持关闭，并且不会发出哔声。

当定时器开启时，快门释放按钮亦可用于手动释放快门。手动释放快门时，定时器将会继续进行倒计时（包括显示面板显示、对焦及释放指示灯和哔声）。若手动释放和自动释放相重合，快门将会保持开启状态直至两个曝光时间结束。

使用上的注意事项

使用EZa前，请先检查电池电量及剩余曝光次数（详细信息，请参阅相机使用手册）。即使相机由于以下原因不能拍摄照片时，定时器也将继续运行：电池电量不足、没有胶卷或内存空间、或内存缓冲区容量不足（仅限于数码相机）。建议使用AC适配器（另行选购）以维持较长时间的供电。

某些相机具有自动对焦激活选项，用于决定相机是否在半按快门释放按钮时进行对焦。使用EZa时，请开启快门释放按钮自动对焦激活选项。

请注意，定时器不如大多数手表和家用时钟准确。

EZa的保养

避免跌落：如果受到强烈碰撞或振动，定时器可能会发生故障。

保持干燥：本产品是非防水产品，如果将其浸入水中或放置于高湿度的环境中将可能发生故障。内部构造生锈可能会导致无法修理的损害。

避免温度骤变：温度的突变，诸如在寒冷天进出温暖的大楼将可能会使定时器内部结露。为避免结露，请将定时器事先装入手提袋或塑料包内，以防温度突变。

远离强磁场：将无线电广播发射机等设备产生的强静电或强磁场可能会干扰本产品正常工作。

关于电子控制设备的注解：在极罕见的情况下，显示面板里会出现一些乱码并且本产品可能会无法工作。这种现象在大多数情况下是由强大的外部静电场所造成的。解决方法是，关闭相机以断开与EZa的连接，待控制面板关闭后取出电池并进行更换。电池使用后会发热，因此更换电池时需小心谨慎。如果故障仍然存在，请咨询您购买定时器的零售商或代理商。

显示面板：LCD显示在温度较高时会显得比较暗，在温度较低时显示反应所需时间较长。这是正常现象，并非故障。

端子型号&对应相机型号

相机遥控线型号	支持相机型号
 C1	佳能EOS 1100D(Rebel T3), 1000D(Rebel XS), 700D, 650D(T4i),600D (Rebel T3i), 60 Da, 60D, 550D(Rebel T2i), 500D(Rebel T1i), 450D(Rebel XSi), 100D 宾得 K200, K110D Super, K110D, K100D, K20D, K10D, K-7, K-5, Kr, Kx, *istDS2, *istDS, *istD, *ist, MZ-6, MZ-L
 C3	佳能EOS 1D Mark IV, 1D(s) Mark III, 1D Mark III, 5D Mark III, 5D Mark II, 1D(s) Mark II,1D Mark II(N), 1D Mark II, 50D, 40D, 30D, 20D, 10D, 7D, 6D, 5D, 1D X, 1D C, 1Ds, 1D, 1V, EOS 3, D2000
 N1	尼康 D800E, D800, D700, D300s, D300, D200, D4, D3S, D3X, D3, D2Xs,D2X, D1X, D2Hs,D2H, D1H, D1,F100, N90s, F90X, F5, F6, F90 富士 S5 Pro, S3 Pro
 N2	尼康 D70S, D80
 N3	尼康 D7100, D7000, D5100, D5000, D3200, D3100, D600, D90
 S1	索尼 A900, A850, A700, A580, A560, A550, A500, A450, A350, A300, A200, A99, A77, A65, A55, A35, A33, A380, A330, A100
 OP12	奥林巴斯 E620, E600, E520, E510, E450, E420, E410, E30, EM5, EP3, EP2, EP1, SP-570UZ, SP-560UZ, SP-550UZ, SP-510UZ, A900, A850, A700, A580, A560

技术规格

支持的相机	尼康、佳能、索尼、三星、松下、宾得、富士、奥林巴斯等多种品牌相机
定时器延迟	0秒至99小时59分59秒（以1秒为增量）
曝光时间	0秒至99小时59分59秒（以1秒为增量）
间隔时间	1秒至99小时59分59秒（以1秒为增量）
拍摄张数	1至399, --（不限定）
电源	两节AAA 1.5V LR03碱性电池
电池寿命	当延迟为5分钟、曝光时间为4分56秒、间隔时间为5分钟时，连续可拍摄时间约两个月。使用照明将会缩短电池寿命。
操作温度	-20°C-50°C
尺寸	约155*40*18mm
重量	约90g
线长	900mm

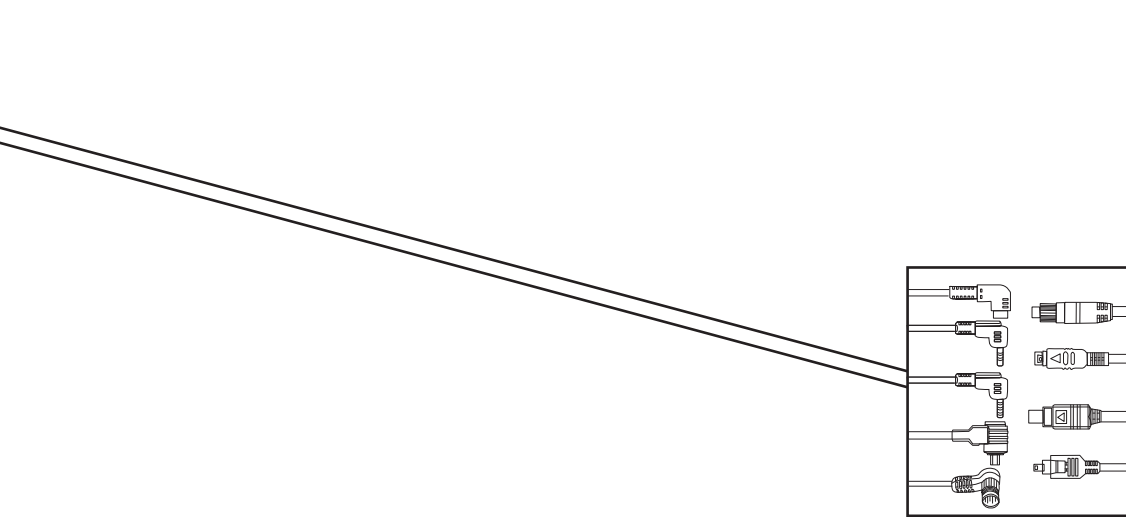

Digital Timer Remote

Instruction Manual

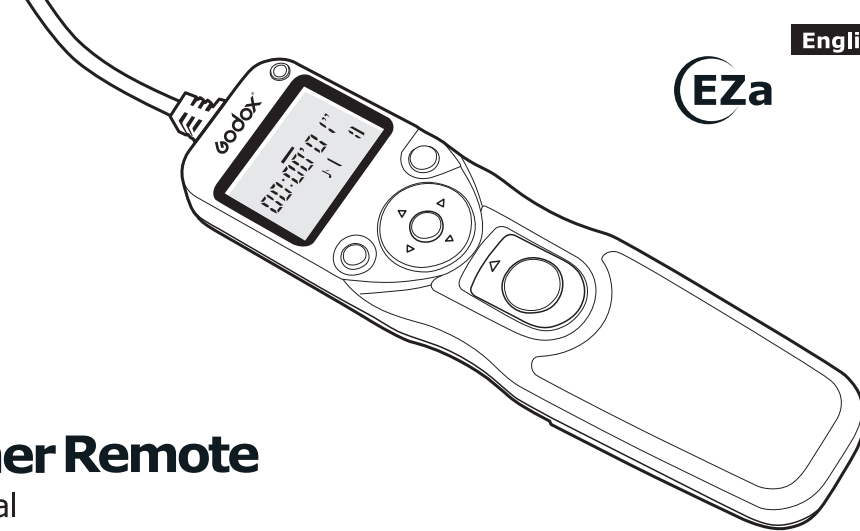

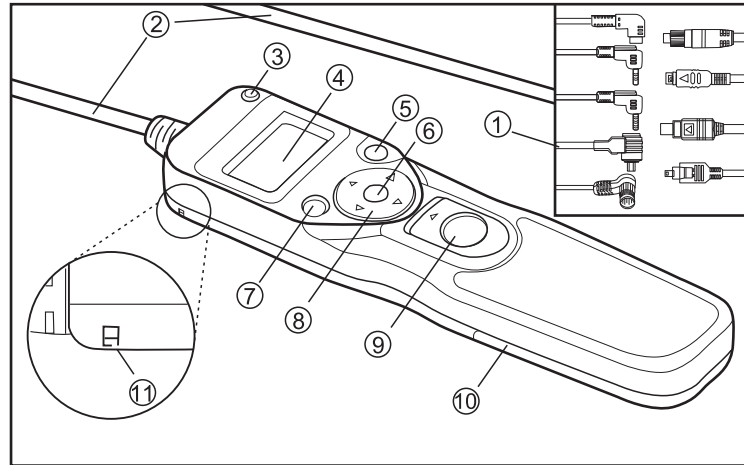

Body:

- (1). Connector
- (2). Cord
- (3). Focus and the release of Two-color indicator light
- (4). Display panel
- (5). TIMER START/STOP button
- (6). SET button
- (7). (Lighting/lock)Button
- (8). Arrow button
- (9). Shutter-release button
- (10). Battery-channel cover
- (11). Straps fixed deduction (available separately; use cell phone or other similar strap)

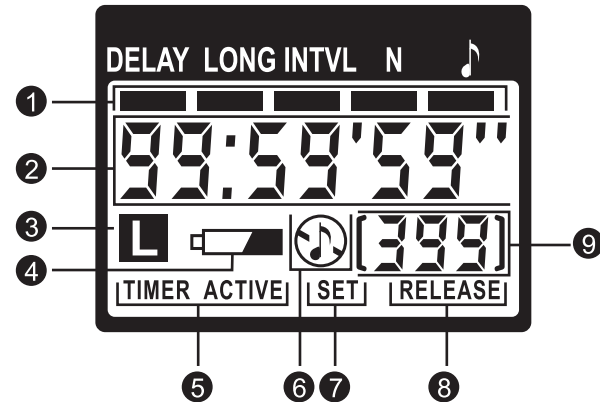

Display Panel:

- (1). Functional cursor
- (2). Show time
- (3). Lock indicator
- (4). Low battery indicator
- (5). "TIMER ACTIVE" indicator
- (6). Speaker on/off indicator
- (7). "SET" indicator
- (8). "RELEASE" indicator
- (9). Number of shots

Contents

Introduction

Thank you for your purchase of an EZa remote cord. The EZa is equipped with an interval timer suited to a wide variety of tasks, including astronomical photography.

For Your Safety 04

Parts Description 01

 Body 01

 Display Panel02

 Inserting Batteries 06

 Replacing Batteries 06

 When the EZa Not In Use 06

 Lighting /Lock Button 07

Connecting the Eza 08

Using the Eza 08

Timed Photography09

Precautions for Use 16

Caring for the Eza 16

Support Model 17

Specifications 18

! For Your Safety

- To prevent damage to your product or injury to yourself or to others, read the following safety precautions in their entirety before using this product. Keep these safety instructions where all those who use this product will read them.
- The consequences that could result from failure to observe the precautions listed in this section are indicated by the following symbol:

! This icon marks warnings, information that should be read before using this product to prevent possible injury.

! Do not disassemble or modify

Failure to observe this precaution could result in electric shock or product malfunction. Should the product break open as the result of a fall or other accident, remove the batteries and send it to an authorized maintenance center if needed.

! Keep dry

Do not handle with wet hands or immerse in or expose to water or rain. Failure to observe this precaution could result in fire or electric shock.

! Do not use in the presence of flammable gas

Failure to observe this precaution could result in explosion or fire.

! Keep out of reach of children

This device contains small parts which may pose a choking hazard. Consult a physician immediately if a child swallows any part of this device.

! Turn off immediately in the event of malfunction

Should you notice smoke or an unusual smell coming from this device, remove the battery immediately and send the device to an authorized maintenance center. Take care to avoid burning. Injury may occur if product operation still continues.

! Do not expose to high temperatures

Do not leave the device in a closed vehicle in the sun or in other areas subject to extremely high temperatures. Failure to observe this precaution could result in fire or in damage to the casing or internal parts.

! Observe precaution when handling batteries

Batteries may leak or explode if improperly handled. Observe the following precautions when handling batteries for use in this device:

- * Use only batteries listed in this manual. Do not mix old and new batteries or batteries of different types.
- * Read and follow all warnings and instructions provided by the manufacturer.
- * Do not short or disassemble.
- * Do not expose to flame or excessive heat.
- * Do not attempt to insert batteries upside down or backwards.
- * Batteries are prone to leakage when fully discharged. To avoid damage to the product, be sure to remove the batteries when leaving the product unattended for prolonged periods or when no charge remains.
- * Should liquid from the batteries come into contact with skin or clothing, rinse immediately with fresh water.

Inserting Batteries:

Slide the battery-chamber cover from the back of the EZa and Insert two AAA 1.5V LR03 alkaline batteries (available separately) as shown.

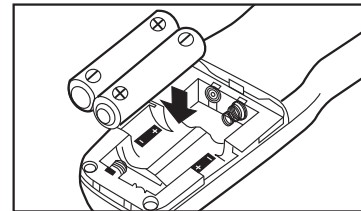

The Low Battery Indicator ()

The low battery indicator will blink when the batteries are low.
(4) Please replace the battery.

When replacing batteries:

1. Check that the “**TIMER ACTIVE**” and “**RELEASE**” indicators are not displayed.
2. Turn the camera off and disconnect the EZa.
3. Remove the batteries.
4. Wait until the control panel has gone out and insert new batteries.

When the EZa is not in use:

The EZa is not equipped with an off switch. To reduce the drain on the batteries when the EZa is not in use, end shooting and check that the “**TIMER ACTIVE**”(5), “**SET**”(7), and “**RELEASE**”(8) indicators are not displayed. The drain on the batteries increases when these indicators are flashing.

The "TIMER ACTIVE""SET" and "RELEASE" indicators

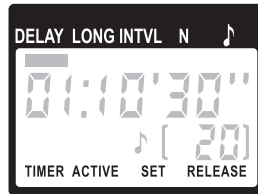

If this flashes	Expression means: Close method
TIMER ACTIVE	Timer active ; press TIMER START/STOP button(⑤)
SET	Settings can be modified; press SET button(⑥)
RELEASE (TIMERACTIVE not flashing)	Manual release active; release shutter button; (⑨) if button is in HOLD position, release shutter-release lock

Lighting/Lock Button:

Press the lighting/lock button (⑦)briefly to activate the control panel backlight. The backlight will remain lit for about six seconds; pressing the arrow button(⑧)while the backlight is on extends the timer for another six seconds.

To lock all controls except the shutter-release (⑨)and Lighting/lock buttons, press the illuminator lock button until the lock icon(**L**) is displayed in the control panel. To release the lock, please press the lighting/lock button until the lock icon is no longer displayed.



Connecting the EZa

1. Turn the camera off.
2. Check that the "**TIMER ACTIVE**" (⑤)and "**RELEASE**"(⑧) indicators are not displayed.
3. Remove the remote cord socket terminal cover from the camera. Insert the connector of this product into the remote cord socket of the camera.

Disconnecting the "TIMER ACTIVE" and "RELEASE"

After the "**TIMER ACTIVE**" (⑤)and "**RELEASE**"(⑧) indicators are not displayed, turn the camera off and disconnect the EZa. Replace the remote cord socket terminal cover.

Using the Eza

The EZa functions as:

An automatic timer.

Choose the delay (time before shooting starts), exposure time, interval, and number of shots for timed interval photography. Shutter speed can be selected with the camera if desired.

A manual release.

Take photographs manually using the shutter-release button on the EZa. Photographs can be taken manually even when the timer is running.

Timed Photography:

1. Adjust Camera Settings

1. 1 Connect the EZa and turn the camera on.
1. 2 Adjust camera settings as follows (see the camera manual for details):

Exposure mode	M (manual)
Shutter speed	Bulb
Interval timer	Off
Focus mode	AF-C (continuous-servo autofocus)*or M (manual)
Continuous	S (Single frame)

2. Set the Timer

2. 1 Press the **SET** button. "SET" will flash in the display panel.



2.2 Adjust the following setting:

Option	Description	Supported setting
DELAY	Delay before shutter is released	0s to 99hrs 59min 59s (in one-second increments)
LONG	Exposure time	
INTVL	Interval	1s to 99hrs 59min 59s (in one-second increments)
N	Number of shots	1 to 399,--(unlimited)
♪	Speaker on/off	♪ On, 🚫 Off

Delay, Exposure, and Interval Settings

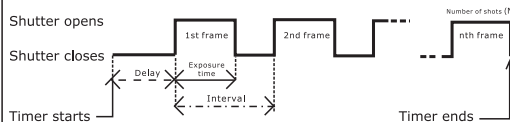

Setting the Timer:

Use the arrow button to set the timer. Press left or right to select, up or down to change. The current selection is indicated by the selection cursor (1).



Adjust settings

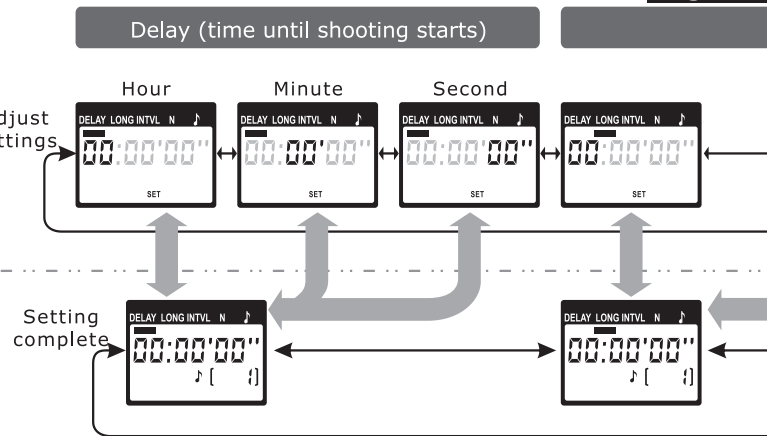

Press **SET**(⑥) at any time to complete the operation and display the new settings for the selected item. To view other settings, press the arrow button left or right. The current selection is indicated by the selection cursor(①). Press the **SET** button to edit the current setting as described above.

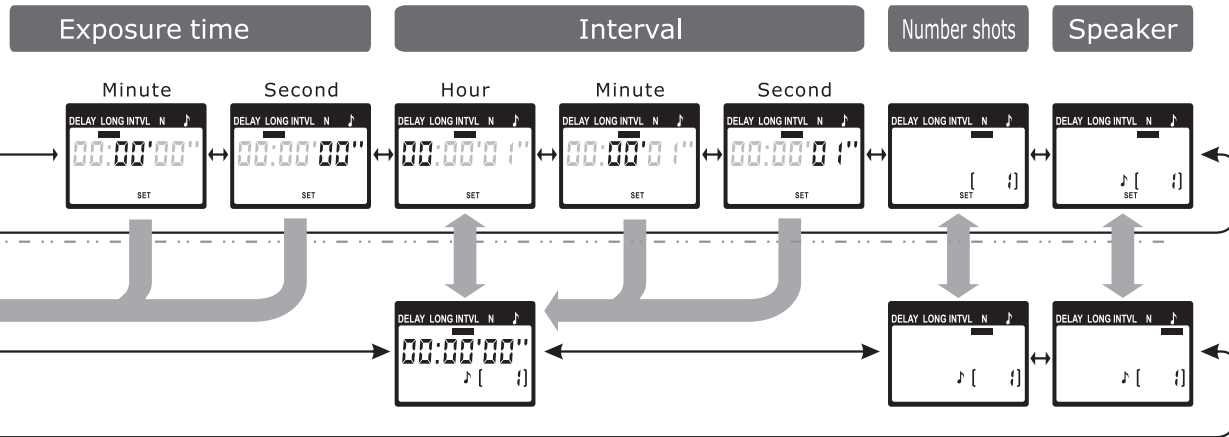

Setting the Timer:

To ensure correct operation, choose an interval at least one second longer than the exposure time. When using autofocus, set the delay to three seconds or more and choose an interval at least three seconds longer than the exposure time to ensure that the camera has time to focus. When using long exposure noise reduction (available with some digital cameras), the interval should be at least twice the exposure time.

Intervals of 00:00:00 will automatically be reset to 00:00:01 when the **SET** button (6) is pressed to put settings into effect.

To set the number of shots to -(unlimited), select **1** and press the arrow button (8) down or select **399** and press the arrow button up.

2.3 After adjusting all settings as desired, press the **SET** button (6) to put the new settings into effect. Timer will issue a beep (speakers in the open circumstances), and the "SET" indicator will go out.

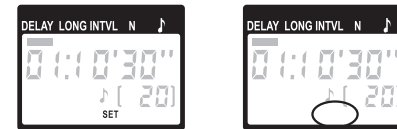

The new setting will remain in effect until changed or until the batteries are removed or exhausted.

3. Start the Timer

Press the **TIMER START/STOP** button (5). The timer will start and "**TIMER ACTIVE**" (5) will flash in the show panel. Between shots, the control panel will show the time remaining until the next photograph is taken. Three second focus output, focus and the release of light-green light.

While the shutter is open, the show panel will show the time remaining until the shutter closes, and the release lamp and "**RELEASE**" indicator (8) will flash at one-second intervals. Focus and the release indicator turns red. If the speaker is turned on, the timer will be issued one second intervals for the beeps. The remaining number of shots will change as soon as one picture is taken.

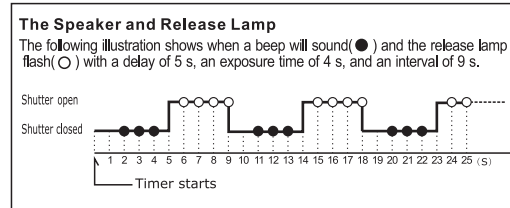
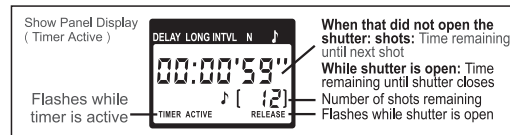

4. End Shooting

Shooting will end automatically when the selected number of shots has been taken. To end shooting before all photographs have been taken, press the **TIMER START/STOP** button (5).

Using the camera to select shutter speed

To take photographs at the shutter speed selected with the camera, adjust setting as follows:

Camera	Exposure mode	M (manual) or S (shutter-priority auto)
	Shutter speed	Any
	Interval timer	Off
	Focus mode	AF-C (continuous-servo autofocus)* or M (manual)
	Shooting mode	S (single frame)
Eza	Exposure time	0s
	Interval	Longer than camera shutter speed**

*Selected "release priority" if available.

**When using autofocus, choose an interval at least two seconds longer than the camera shutter speed to allow the camera time to focus. When using long exposure noise reduction (available with some digital cameras), choose an interval at least double the camera shutter speed.

Using the timer

Before using the timer for extended periods, check that the batteries have enough charge. Replace the batteries when the low battery indicator flashes () in the show panel (4).

Manual Release

The Eza shutter-release button (9) functions in much the same way as the camera shutter-release button.

1. Adjust camera settings

Connect the Eza and turn the camera on. Choose exposure mode, shutter speed, focus mode, and shooting mode as desired.

2. Take pictures

2.1 Press the Eza shutter-release button halfway and check focus and exposure, focus and the release of bright green light. And then click to complete their photographs. When the shutter opens, focus and the release indicator get red. Every one second the camera sounds a beep, the "**RELEASE**" indicator (8) will flash, and the display will show the shutter has opened the time.

Keep the shutter-release button fully pressed for bulb photography. Slide the button to the **HOLD** position. Slide it in the opposite direction to release the lock.



2. 2 Release the button to end shooting.

The EZa shutter-release button can be used when no batteries are inserted. The show panel will remain off and no beep will sound.

The shutter-release button can be used to release the shutter manually while the timer is active. Timer count-down (including display panels, focus and the release of the indicator light and beep). If a manual release overlaps with an automatic release, the shutter will remain open until both exposure times have expired.

Precautions for use

Check the camera battery level and number of exposures remaining before using the EZa(see the camera manual for details). The timer will continue to operate even when no pictures can be recorded due to low battery, lack of film or memory, or lack of space in the memory buffer (digital cameras only). An AC adapter(available separately) is recommended for longer sessions.

Some cameras have an AF activation option that determines whether the camera will focus when the shutter-release button is pressed halfway (see the camera manual for details). Enable shutter-release button AF-activation when using the EZa.

Please note that the timer is less accurate than most watches or household clocks.

Caring for the EZa

Do not drop: The product may malfunction if subjected to strong shocks or vibration.

Keep dry: This product is not waterproof and may malfunction if immersed in water or exposed to high levels of humidity. Rusting of the internal mechanism can cause irreparable damage.

Avoid sudden changes in temperature: Sudden changes in temperature, such as occur when entering or leaving a heated building on a cold day, can cause condensation inside the device. To prevent condensation, place the device in a carrying case or a plastic bag before exposing it to sudden changes in temperature.







Keep away from strong magnetic fields: Strong static charges or the electromagnetic fields produced by equipment such as radio transmitters could interfere with the device.

A note on electronically-controlled devices:

In extremely rare instances, unusual characters may appear in the show panel and the device may stop functioning. In most cases, this phenomenon is caused by a strong external static charge. Turn the camera off, disconnect the EZa, remove the batteries, and then replace them once the control panel has turned off. Caution is required when handling the batteries, which may be hot after use. In the event of continued malfunction, contact your retailer or representative.

Display panel: LCD displays tend to darken at high temperatures and exhibit slower response times at low temperatures. This does not indicate a malfunction.

Support Model

Terminals Models	Supporting Camera Model
 C1	Canon EOS 1100D(Rebel T3), 1000D(Rebel XS), 700D, 650D(T4i), 600D (Rebel T3i), 60 Da, 60D, 550D(Rebel T2i), 500D(Rebel T1i), 450D(Rebel XSi), 100D Pentax K200, K110D Super, K110D, K100D, K20D, K10D, K-7, K-5, Kr, Kx, *istDS2, *istDS, *istD, *ist, MZ-6, MZ-L
 C3	Canon EOS 1D Mark IV, 1D(s) Mark III, 1D Mark III, 5D Mark III, 5D Mark II, 1D(s) Mark II, 1D Mark II(N), 1D Mark II, 50D, 40D, 30D, 20D, 10D, 7D, 6D, 5D, 1D X, 1D C, 1Ds, 1D, 1V, EOS 3, D2000
 N1	Nikon D800E, D800, D700, D300s, D300, D200, D4, D3S, D3X, D3, D2Xs, D2X, D1X, D2Hs, D2H, D1H, D1, F100, N90s, F90X, F5, F6, F90 Fujifilm S5 Pro, S3 Pro
 N2	Nikon D70S, D80
 N3	Nikon D7100, D7000, D5100, D5000, D3200, D3100, D600, D90
 S1	Sony A900, A850, A700, A580, A560, A550, A500, A450, A350, A300, A200, A99, A77, A65, A55, A35, A33, A380, A330, A100
 OP12	Olympus E620, E600, E520, E510, E450, E420, E410, E30, EM5, EP3, EP2, EP1, SP-570UZ, SP-560UZ, SP-550UZ, SP-510UZ, A900, A850, A700, A580, A560

Specifications

Supported cameras	Nikon, Canon, Sony, Samsung, Matsushita, Peheax, Olympus, Konica Minolta, etc.
Timer delay	0s to 99hrs 59min 59s in one-second increments
Exposure time	0s to 99hrs 59min 59s in one-second increments
Interval	1s to 99hrs 59min 59s in one-second increments
Number of shots	1 to 399, --(unlimited)
Power source	Two AAA 1.5V LR03 alkaline batteries
Battery life	Approximately two months of continuous shooting with a delay of 5min, an exposure time of 4 min 56s, and an interval of 5min. Use of the illuminator will reduce battery life.
Operating temperature	-20°C+50°C(-4°F+122°F)
Dimensions	Approximately 155 x 40 x 18mm(6.1 x 1.6 x 0.7in.), excluding projections
Weight	Approximately 90g
Length of cord	Approximately 900mm