

深圳市神牛摄影器材有限公司

GODOX PHOTO EQUIPMENT CO. LTD

地址/ Add : 深圳市罗湖区莲塘金田工业区A座6楼
6/F, Building A, Liantang Jintian Industrial Zone,
Luohu District, Shenzhen 518004, China

电话/ Tel : +86-(0)755-25701197 25729622

传真/ Fax : +86-(0)755-25723423 25706155

邮箱/ E-mail : godox@godox.com

Godox®

神牛®

MC^{SERIES}

无线快门遥控器

使用说明书

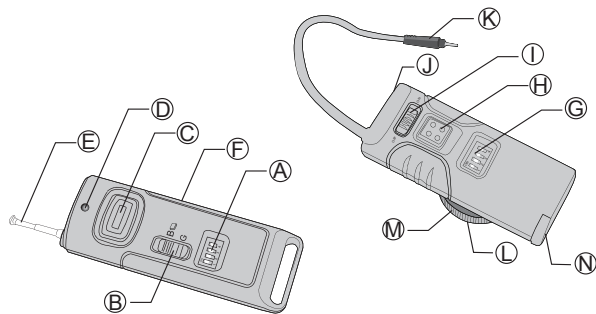

图示说明

1. 发射器

A) 频道编码开关

B) 功能选择档

B: B门模式, 连拍模式,
单次拍摄模式

G: 延时 (约5秒) 拍摄

C) 快门按钮开关

D) 信号双色指示灯

E) 信号天线

F) 电池仓

2. 接收器

G) 频道编码开关

H) 快门手动按钮开关

I) 电源开关

J) 信号双色指示灯

K) 连接各种相机快门插座的
终端插头

L) 标准热靴插头

M) 锁紧螺栓

N) 电池仓

目录

图示说明	2
安全需知	4
产品介绍	7
安装电池	8
更换电池	9
低电量指示	9
遥控操作	10
性能参数	12
频道设定	13
各端子支持的相机型号	14
注意事项	17

安全需知

为防止损坏您的产品，或避免您或他人受伤，在使用本设备前请仔细阅读下面的安全需知，并妥善保管以便所有本产品使用者可随时参阅。

请遵守本节中所列举的用以下符号所标注的各项预防措施，否则可能对产品造成损害。

⚠ 请勿拆卸或改造

违反此警告可能会触电或导致产品故障。若本产品因为摔落或其他意外事故造成破损，请取出电池并将本产品送至当地的维修中心进行检查维修。

▲ 保持干燥

请勿用湿手接触产品，亦不可将产品浸入水中或暴露于雨中，否则可能引起火灾或触电。

▲ 请勿在易燃气体环境中使用

违反此警告可能引起爆炸或火灾。

▲ 请勿在儿童伸手可及之处保管本产品

本产品包含可能引起窒息的零件。如果儿童不小心吞食了零件，请立即送往医院救治。

▲ 请勿置于高温中

请勿将本产品放置于阳光直射下的封闭车辆内或其他极高温度的地方，否则可能导致火灾或损坏本产品的外壳或内部部件。

▲ 使用电池的注意事项

操作不当可能导致电池漏液或爆裂，因此在本产品中使用电池时请注意以下事项：

- 只能使用本手册中列出的电池。请勿混用新旧电池或不同类型的电池。
- 请仔细阅读并遵守由厂商提供的警告和指示。
- 切勿使电池短路或拆卸电池。
- 切勿将电池投入火中或加热升温。
- 切勿试图以反方向安装电池。
- 当电量用尽时，电池容易漏液，所以为了避免产品受损，请在长期不使用本产品或电量用尽时取出电池。
- 如果受损电池中的液体接触到皮肤或衣服，请立即用大量清水冲洗。

产品介绍

感谢您购买无线远程快门遥控器，该产品适合多种拍摄任务，它不需要一条连接着手和相机的长长的线就可以对快门进行控制，请参考14页各端子支持的相机型号。

主要特点如下：

- 远程无线控制，在开阔空间距离可达100米。
- 16种调频选择适合多摄影师同时拍摄环境。
- 强力抗干扰能力。
- 电池低电量提示。
- 超低电耗设计，给您更长的使用时间。
- 具备B门和连续快门功能（须对相机做相应设置）
- 具备延时拍摄功能。
- 接收器具有手动控制功能，作为有线快门线使用。

安装电池

发射器

从发射器的后面滑下电池盖（F），然后装入一个12V23A电池（包装中已经包含此电池）。

接收器

从接收器的后面滑下电池盖（N），然后装入一个2个AAA，1.5伏的碱性电池。

更换电池

更换发射器或接收器里的电池步骤：

- 1) 把接收器上的ON/OFF开关设置到“OFF”状态
- 2) 关掉相机并断开接收器
- 3) 取出电池

低电量指示

当接收器上的指示灯快速的闪动时，表示电池电量过低，该换电池了。

遥控操作

- 1) 先关闭相机电源；
- 2) 将接收器插头与相机连接好，打开相机与接收器的电源；
- 3) 按动发射器上的快门开关，指示灯与接收器上的指示灯闪烁一致，即可进行工作；
- 4) B快门：先把相机设置B门拍摄模式，长按发射器按钮开关待红色指示灯亮直至熄灭（约3秒）即放开按钮；接收器上红色指示灯一直亮，表示在执行B门拍摄功能；需解除B门，再按发射器按钮开关即可。
- 5) 连拍模式：先把相机设置连拍模式，长按发射器待红灯亮直至熄灭（约3秒）即放开按钮，此时接收器自动转入连拍状态；需解除连拍，再按发射器按钮开关即可。

6) 延时拍摄模式：先把发射器功能档拨到延时功能档位，轻按下发射器的快门按钮开关，显示绿色表示在对焦，再深按，灯变为红色，保持按住状态直至红色指示灯熄灭，此时接收器上红色指示灯闪烁约5秒后，触发相机快门动作，完成拍摄。

7) 有线手动控制模式：接收器可作为有线快门线使用，按下接收器的快门按钮开关，触发相机快门动作，完成拍摄。此模式下，不需电池电源支持。

8) 群拍模式：把快门器上的频道开关设置在同一位置，多个接收器插在多部相机快门插座上，可以实现一个发射器控制多个接收器，实现多部相同或不同型号的相机同时拍摄。

性能参数：

产品名称	发射器	接收器
电池	12V23A 小型电池	2*1.5VAAA七号碱性电池
电池使用寿命	连续触发20000次	待机依不同电池容量而定
频道	16	16
远程控制距离	100米（无干扰开阔地）	-----
工作指示灯	双色LED指示	双色LED指示
无线频率	433赫兹	-----

频道设定

先关闭接收器的电源，把发射器和接收器上编码开关的位置调成一致，即同一频道（共16个频道），再打开电源即可工作。

频道	1	2	3	4	5	6	7	8
接收器	NO 1234	NO 1234	NO 1234	NO 1234	NO 1234	NO 1234	NO 1234	NO 1234
发射器	NO 1234	NO 1234	NO 1234	NO 1234	NO 1234	NO 1234	NO 1234	NO 1234
频道	9	10	11	12	13	14	15	16
接收器	NO 1234	NO 1234	NO 1234	NO 1234	NO 1234	NO 1234	NO 1234	NO 1234
发射器	NO 1234	NO 1234	NO 1234	NO 1234	NO 1234	NO 1234	NO 1234	NO 1234

各端子支持的相机型号

C1

C1适合所有兼容原厂佳能RS-80N3快门线相机

Pentax K100D, K110D, K10D, *ist Ds2, *ist D, *ist Ds, *ist, *ist DL, *ist DL2

Samsung GX-1L, GX-1S, GX-10

Canon EOS 30, 33, 50E, 300, 300V, 3000, 50, 300D(Digital Rebel), 350D(Digital Rebel XT), 400D(Digital Rebel XTi), 450D(Digital Rebel XSi), 500D, 1000D

C3

C3适合所有兼容原厂佳能RS-60E3快门线相机

Canon EOS 1Ds Mark II, 1Ds Mark III, 1Ds, 1D Mark IV, 1D Mark II, 1D Mark II N, 1D Mark III, 5D Mark II, 1D, 5D, 7D, 50D, 40D, 30D, 20D, 10D, D60, D30, D2000, 1v HS, 1v, 3

N1**N1适合所有兼容尼康MC-30快门线的相机**

Nikon D2H,D2Hs, D1x, D1h, D1, D2x, D2Xs, D200, D300, D3, D3X, D3S, D2HS,
D300S, D700, F5, F6, F100, F90, F90x,
Nikon D100 (MB-D100 Vertical Grip / Battery Holder needed)
Kodak DCS-14n
Fujifilm Finepix S3pro, S5pro

N2

Nikon D70S, D80

N3**N3适合MC-DC2快门线**

Nikon D90, Nikon D5000

S1**S1适合所有兼容索尼RM-S1AM\RM-L1AM快门线相机**

Sony Alpha DSLR-A100, SLR-A200, SLR-A300, SLR-A350, SLR-A700, SLR-A900,
Alpha 5D, Alpha 7D
Minolta Maxxum/Dynax/AF 7D, 5D, 9, 7, 5 4, 3, 807si, 800si, 700si, 600si, 505si,
500si, Sweet, Sweets, 9000, 7000, 5000, DiIMAGE 7Hi, 7i, 7, 5

OP3

Olympus E1, E3, E10, E20, E20N, E100RS, C2500L, E300(via the HLD3 power
battery holder) C8080WZ(via the B-HLD30 power battery holder), C7070WZ(via
the B-HLD20 power battery holder), C5060WZ(via the B-HLD20 power battery
holder)

OP12

Olympus SP-510UZ, SP-550UZ, E400, E410, E510, E450, E520, E420

注意事项

- 1) 请使用规定的电池；
- 2) 电池将耗尽时，会现漏闪现象，应及时更换电池；
- 3) 不要在相机电源开启状态下连接或卸下接收器；
- 4) 为了在操作中不出现问题，务必使插头接插牢靠。
- 5) 严禁接触水或放置到高温环境中。



Wireless Remote Shutter

INSTRUCTION MANUAL

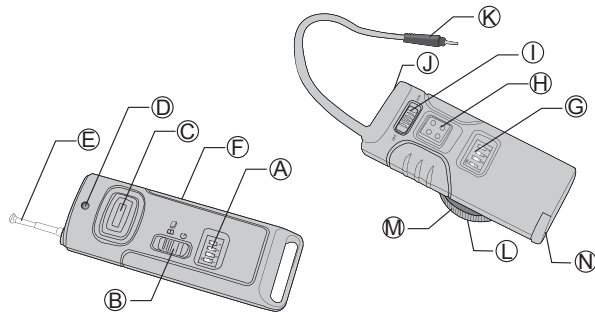

Nomenclature:

1. Transmitter:

- A) Channel switches.
- B) Function selecting switch
B: B shutter, Continuous shooting,
Single shooting
- G: Delay shooting(5sec)
- C) Shutter triggering button
- D) Double color LED indicator.
- E) Signal Antenna
- F) Transmitter battery grip

2. Receiver:

- G) Channel code switches
- H) Manual triggering button
- I) Power switch
- J) Double color LED indicator
- K) Terminal plug
- L) Standard hot shoe
- M) Fastening bolt
- N) Receiver battery grip

Table of Content:

Nomenclature.....	2
For Your Safety.....	4
Introduction.....	7
Inserting Battery.....	8
Replacing Battery.....	9
The Low Battery Indicator.....	9
Operation.....	10
Specification.....	13
Channel Selecting.....	14
Support model.....	15
Precautions for Use.....	19

For Your Safety:

To prevent damage to your product or injury to yourself or to others, read the following safety precautions in their entirety before using this equipment. Keep these safety instructions where all those who use this equipment will read them.

⚠ Do not disassemble or modify

Failure to observe this precaution could result in electric shock or product malfunction. Should the product break open as the result of a fall or other accident, remove the batteries.

⚠ Keep dry

Do not handle with wet hands or immerse in or expose to water or rain. Failure to observe this precaution could result in fire or electric shock.

⚠ Do not use in the presence of flammable gas

Failure to observe this precaution could result in explosion or fire.

⚠ Keep out of reach of children

This device contains small parts which may pose a choking hazard. Consult a physician immediately if a child swallows any part of this device.

⚠ Do not expose to high temperatures

Do not leave the device in a closed vehicle under the sun or in other areas subject to extremely high temperatures. Failure to observe this precaution could result in fire or in damage to the casing or internal parts.

⚠ Observe precaution when handling batteries

Batteries may leak or explode if improperly handled. Observe the following precautions when handling batteries for use in this device:

- Use only batteries listed in this manual. Do not mix old and new batteries or batteries of different types.
- Read and follow all warnings and instructions provided by the manufacturer.
- Do not short or disassemble.
- Do not expose to flame or excessive heat.
- Do not attempt to insert batteries upside down or backwards.
- Batteries are prone to leakage when fully discharged. To avoid damage to the product, be sure to remove the batteries when leaving the product unattended for prolonged periods or when no charge remains.
- Should liquid from the batteries come into contact with skin or clothing, rinse immediately with fresh water.

Introduction:

Thank you for your purchase of wireless remote shutter. The product is suited to a wide variety of tasks, see page 15 for Support model. It offers complete control of camera shutter without cumbersome cable connections between the hand control units and the camera.

Please refer to the main features as follows:

- Remote wireless control, effective remote shutter distance(open space): 100m.
- 16-unique-channel supports multiple users' environment.
- Strong interference-resistance capacity.
- Exhausted power consumption design benefits a longer period of use.

- Wireless bulb shutter and continuous shooting function(Corresponding function setting is required for camera).
- Delay shooting function.
- Manual-control as cable shutter shooting function of the receiver.

Inserting Batteries:

Transmitter:

Slide the battery-chamber cover(F) from the back of the transmitter and insert one 12V/23A battery (enclosed in package).

Receiver:

Slide the battery-chamber cover (N) from the bottom of the receiver and insert two AAA 1.5V alkaline batteries.

Replacing Batteries:

When replacing batteries on transmitter or receiver:

- 1) Check the receiver is on the "off" position
- 2) Turn the camera off and disconnect the receiver
- 3) Remove the batteries.

The Low Battery Indicator:

LED indicator on receiver blinking fast when the batteries are low, ready change batteries.

Operation:

- 1) First switch off the camera.
- 2) Put the plug of the receiver into the camera, and turn on both of them.
- 3) Press the shutter release switch of the transmitter, and make sure the LED indicator blinks consistently with the receiver LED indicator, then they works.
- 4) Bulb Shutter: Set your camera to Bulb mode. Long press the transmitter's button, the red LED indicator lights and wait until it goes out (approximately three seconds). If the red LED indicator on the receiver is light, it indicates Bulb shutter function is carrying on; To cancel this function, please press the transmitter's button again.

5) Continuous Shooting Mode: Please set your camera on continuous mode. Long press the transmitter's button, the red LED indicator lights and wait until it goes out (approximately three seconds). Now the receiver automatically switches to continuous shooting mode; To cancel continuous shooting, please press the transmitter's button.

6) Delay Shooting Mode: Please pull the transmitter's function selecting switch to the place for delay shooting, half press the button on the transmitter, focusing is going on when the LED indicator turns green, then full press the button, the LED indicator turns red, and keep pressing until the red goes out. At this time, the red LED indicator on the receiver blinks for five seconds, after that the camera shutter is triggered, and the shooting completes.

7) Cable-manual Controlling Mode: The receiver can be used as cable shutter. Press the button of the receiver, to trigger the shutter of the camera, then the shooting completes. No battery power supporting at this mode.

8) Multi-shooting Mode: Set channel codes on the wireless remote release at the same place, and multiple receivers are inserted into multiple cameras, to realize the operation that one transmitter controls multiple receivers and multi-shooting from cameras with the same model or different models.

Specifications:

Item name	Transmitter	Receiver
Power supply	12V/23A battery	2 x 1.5V/AAA alkaline battery
Battery life	Continuous press for 20,000 times	Standby depends on different battery capacity
QTY of channel	16	16
Remote control distance	100m (open space without jamming)	_____
Work indicator	Double color LED indicator	Double color LED indicator
Wireless frequency	433MHZ	_____

Channel Selecting:

Please switch off the power of the receiver, then keep both the transmitter and receiver the same channel codes, and switch on the power to work again.

Channel No.	1	2	3	4	5	6	7	8
Receiver	NO □□□□ 1234	NO □□□□ 1234	NO □□□□ 1234	NO □□□□ 1234	NO □□□□ 1234	NO □□□□ 1234	NO □□□□ 1234	NO □□□□ 1234
Emitter	NO □□□□ 1234	NO □□□□ 1234	NO □□□□ 1234	NO □□□□ 1234	NO □□□□ 1234	NO □□□□ 1234	NO □□□□ 1234	NO □□□□ 1234

Channel No.	9	10	11	12	13	14	15	16
Receiver	NO □□□□ 1234	NO □□□□ 1234	NO □□□□ 1234	NO □□□□ 1234	NO □□□□ 1234	NO □□□□ 1234	NO □□□□ 1234	NO □□□□ 1234
Emitter	NO □□□□ 1234	NO □□□□ 1234	NO □□□□ 1234	NO □□□□ 1234	NO □□□□ 1234	NO □□□□ 1234	NO □□□□ 1234	NO □□□□ 1234

Support model:

C1

Pentax K100D, K110D, K10D, *ist Ds2, *ist D, *ist Ds, *ist, *ist DL, *ist DL2
 Samsung GX-1L, GX-1S, GX-10
 Canon EOS 30, 33, 50E, 300, 300V, 3000, 50, 300D(Digital Rebel),
 350D(Digital Rebel XT), 400D(Digital Rebel XTi), 450D(Digital Rebel
 XSi), 500D, 1000D

C3

Canon EOS 1Ds Mark II, 1Ds Mark III, 1Ds, 1D Mark IV, 1D Mark II, 1D
 Mark II N, 1D Mark III, 5D Mark II, 1D, 5D, 7D, 50D, 40D, 30D, 20D,
 10D, D60, D30, D2000, 1v HS, 1v, 3

N1

Nikon D2H,D2Hs, D1x, D1h, D1, D2x, D2Xs, D200, D300, D3, D3X, D3S,
 D2HS, D300S, D700, F5, F6, F100, F90, F90x,
 Nikon D100 (MB-D100 Vertical Grip / Battery Holder needed)
 Kodak DCS-14n
 Fujifilm Finepix S3pro, S5pro

N2

Nikon D70S, D80

N3

Nikon D90, Nikon D5000

S1

Sony Alpha DSLR-A100, SLR-A200, SLR-A300, SLR-A350, SLR-A700, SLR-A900, Alpha 5D, Alpha 7D

Minolta Maxxum/Dynax/AF 7D, 5D, 9, 7, 5 4, 3, 807si, 800si, 700si, 600si, 505si, 500si, Sweet, Sweets, 9000, 7000, 5000, DiMAGE 7Hi, 7i, 7, 5

OP3

Olympus E1, E3, E10, E20, E20N, E100RS, C2500L, E300(via the HLD3 power battery holder) C8080WZ(via the B-HLD30 power battery holder), C7070WZ(via the B-HLD20 power battery holder), C5060WZ(via the B-HLD20 power battery holder)

OP12

Olympus SP-510UZ, SP-550UZ, E400, E410, E510, E450, E520, E420

Precautions for Use:

- 1) Use only the prescribed battery.
- 2) Please change batteries before they run down in case of shot omission.
- 3) Please do not connect or disassemble the receiver under the state of camera power-on.
- 4) Please do make the connector connected firmly to avoid problems in operation.
- 5) Avoid water and hot environment conditions.